

THO 00097

THO 00097

KLINGER SURVEY
 THOMPSON TOWNSHIP
 GEauga COUNTY, OHIO
 LOTS NO. 9 AND 10

GRAPHIC SCALE

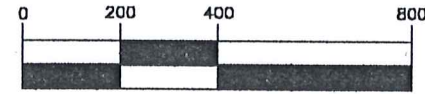

(IN FEET)
 1 inch = 400 ft.



DAVID MIHALIK
 VOL. 952 P. 527

CLAY STREET 60' WIDE

N 3°02'47"E
 850.88'

341.98'

JOSEPH F. NOVAK
 ANNETTE MELI NOVAK
 VOL. 1275 P. 1072

I hereby certify that I have surveyed these premises and prepared this map in accordance with the provisions of Chapter 4733-37 of the Ohio Administrative Code.

William R. Loetz APRIL 24, 2003

William R. Loetz
 Ohio Registered Surveyor No. 7552
 APRIL, 2003

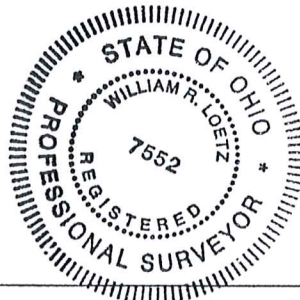

JOSEPH F. NOVAK
 ANNETTE MELI NOVAK
 VOL. 1275 P. 1072

IRON PIN SET
 AT 30.00'

IRON PIN SET
 AT 30.00'

IRON PIN SET
 AT 30.00'

S 86°02'03" E 3070.57' to CL

S 86°02'03" E 1100.00' to CL
 LOT ACREAGE 5.050

N 86°02'03" W 1100.00' to CL

H. JACK KLINGER
 JEAN KLINGER
 VOL. 1498 PAGES 1015

LOT ACREAGE 59.869
 5.050
 54.819

N 86°01'23" W 3057.93' to CL

1100.00' to CL

S 3°53'50"W

851.36'

N 3°53'50"E

372.43'

R. BRUCE REMELY
 CELENE M. REMELY
 VOL. 749 P. 779

LINDA M. WRIGHT
 VOL. 818 P. 708

LINDA M. WRIGHT
 VOL. 818 P. 708

PAUL A. DRISCOLL
 DEBORAH L. DRISCOLL
 VOL. 1368 P. 719

5/8" IRON
 PIN FOUND
 AT STATION
 138+67.98

LEGEND

○ 1" IRON PIN FOUND

● 3/4" IRON PIN SET

PROPERTY OWNERSHIP:

H. JACK KLINGER
 JEAN KLINGER
 DEED:
 VOL. 1498 PAGES 1015
 ADDRESS:
 7183 CLAY STREET
 THOMPSON, OH 44086

SURVEY PLAT & LEGAL DESCRIPTION
 APPROVED PER R.C. 315.251

JK

4/25/03

OFFICE OF THE
 GEauga COUNTY ENGINEER

THO-00097

THO 00097

KLINGER
PICKED up 4/25/03

30-095824

Vol. 1708-Pg. 140

LEGAL DESCRIPTION 5.050 ACRES

Situated in the Township of Thompson, County of Geauga, and State of Ohio, and known as Original Lot No. 9 and 10 in said Township and further described as follows:

Beginning at a 5/8" iron pin found at the angle point on the centerline of Clay Street (60 feet wide) at county centerline station (138+67.98). Thence, North 3° 02' 47" East, along said centerline a distance of 341.98 feet to the Northwesterly corner of land conveyed to J. F. and A. M. Novak in Volume 1275 Page 1072 of Geauga County Records; Thence, North 3° 02' 47" East, along said centerline of Clay Street a distance of 650.88 feet to and the **Principle Place of Beginning** of the parcel herein described;

Thence, North 3° 02' 47" East, along said centerline of Clay Street a distance of 200.00 feet to the Southwesterly corner of land conveyed to David Mihalik in Volume 952 Page 527 of Geauga County Records;

Thence, South 86° 02' 03" East, along said Mihalik Southerly line passing through a 3/4" iron pin set at 30.00 feet, and a total distance of 1100.00 feet to a 3/4" iron pin set;

Thence, South 3° 02' 47" West, a distance of 200.00 feet to a 3/4" iron pin set;

Thence, North 86° 02' 03" West, passing through a 3/4" iron pin set at 1070 feet and a total distance of 1100 feet to the **Place of Beginning**, containing 5.050 acres of land, more or less, subject to all legal highways as surveyed April, 2003 by William R. Loetz RLS Ohio No. S/7552. Bearings shown herein are to an assumed meridian and are used to denote angles only.

PREVIOUS RECORDING VOL. 1498, PAGE 1015

William R. Loetz APRIL 24 2003



OFFICE OF THE
GEAUGA COUNTY ENGINEER
APPROVED PER R.O. 315.261
SURVEY PLAT & LEGAL DESCRIPTION
4/25/03